



# INSTRUCTIONS

## Retractable Gate

**7328**
**F820AL (white)**  
**F1012AL (grey)**

 Patent No. 11/604,922  
 EN1930:2011

## IMPORTANT! READ AND FOLLOW THESE INSTRUCTIONS CAREFULLY AND KEEP FOR FUTURE REFERENCE

Read the entire instructions before assembling and installing this product.  
If you sell or give away this product, make sure you give this instruction to the new owner.

### WARNING

**WARNING**– Incorrect installation can be dangerous.

**WARNING**– Do not use the safety barrier if any components are damaged or missing.

**WARNING**– The safety barrier must not be fitted across windows.

**WARNING**– Never use this gate without securely installed Locking Brackets and Locking Hooks.

This safety barrier conforms to EN1930:2011;

This safety gate is for domestic use only; This safety gate has been designed for use with children up to 24 months of age; Never use with a child able to climb over or dislodge/open the gate; The surfaces that the gate is to be fixed to must be suitable for the purpose and must be structurally sound;



**WARNING:** This package contains small parts and sharp points in an unassembled state. Keep out of reach of children. Adult assembly required.

The clearance space between the Base of Casing and the floor MUST NOT exceed 0.3cm (0.12in);  
If the safety barrier is used at the bottom of the stairs, it should be positioned at the front of the lowest tread possible;  
If the safety gate is used at the top of the stairs to prevent child falling down the stairs, it must not be placed on any stair below the level of the top stair;

At the top of landing, position the gate 15cm away from the top step;

This safety gate has a manual close system; This safety gate must NEVER be used as a pool or pond barrier; Never leave a child unattended. This safety gate does not replace proper adult supervision.

### PARTS LIST

- Included**
- A** Gate Panel
  - B** Cover
  - C** Upper Bracket
  - D** Lower Bracket
  - E** Upper Hook
  - F** Lower Hook
  - G** Locking Rod
  - H** Screws 4x25mm (5/32 x 1in) (x8)
  - I** Masonry/Brick Plugs (x8)
  - J** Templates (x2)

#### Skirting Board Kit

- A1/2** Bracket Spacer
- X1/2** Hook Spacer
- AX** 4 x Spacer Screws

- Pre-assembled**
- K** Base of Casing
  - L** Top of Casing
  - M** Release Button

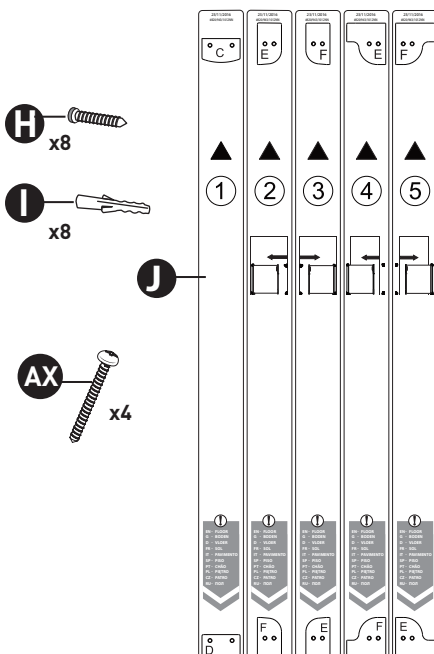

#### Before you start

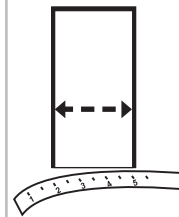

This gate can cover an area of up to 140cm (55in).

Have on hand a tape measure, pencil, drill with 4mm (5/32 x 1in) drill bit and a Phillips head screwdriver.

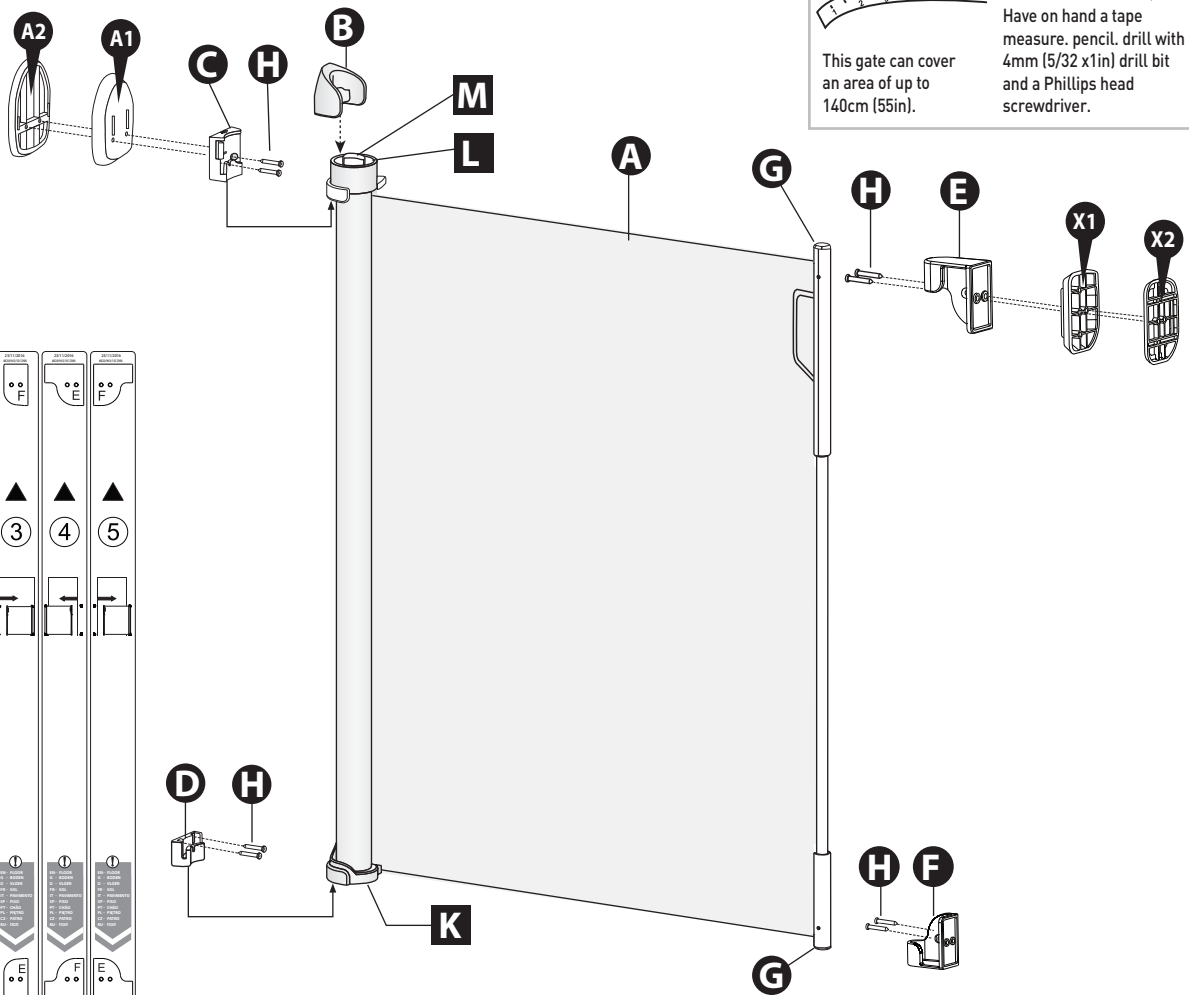

## 1. Choose best location for gate

**!** Ensure the surface you are mount the gate is structurally sound such as solid timber, brick or masonry. For plaster/gyprock surface, locate the timber beam or stud behind and mount in this location (mounting on plaster/gyprock alone is not strong enough and not safe). Do not mount to glass.



mounted  
inside  
opening

MIN – 20cm/8in  
MAX – 140cm/55in

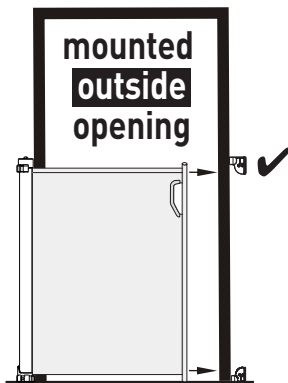

mounted  
outside  
opening

MIN – 20cm/8in  
MAX – 129cm/51in

**1a.** Gate can be installed outside or inside door openings

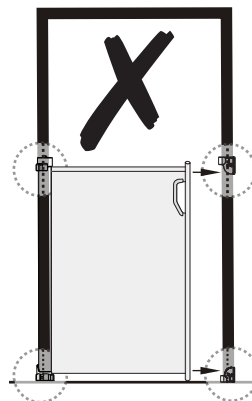

**!** The edge of brackets should NOT be over the door frame (or wall) edge after assembling.

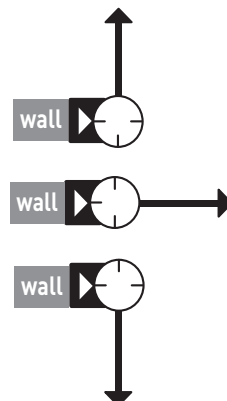

**1b.** Opening direction of the gate can be changed to suit

### **!** Bottom of stairs

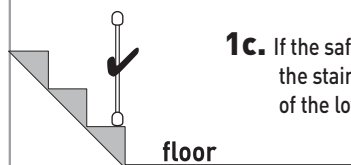

**1c.** If the safety barrier is used at the bottom of the stairs, it should be positioned at the front of the lowest tread possible.

### **!** Top of stairs

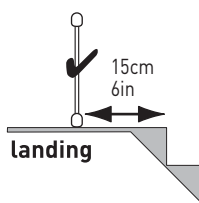

**1d.** If the safety barrier is used at the top of stairs, it should not be positioned below the top level. At the top of landing, position the gate 15cm away from the top step.

### Top view of gate



**1e.** Make sure that the gate is mounted firmly and evenly in vertical position.

### Side view of gate

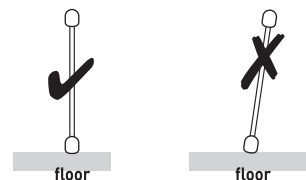

## 1f. Skirting Board Kit

If there is a skirting board to which the Retractable Gate is to be attached, build up the wall areas equivalent to thickness of skirting board with Spacers (included).

Replace Screw **H** with **AX** Spacer Screws

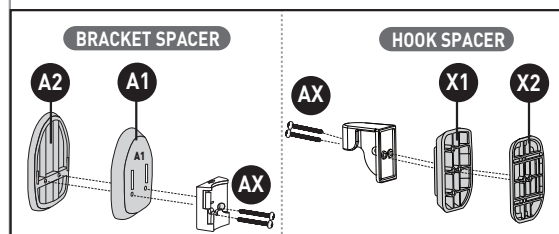

For 1.25cm (1/2in) skirting board use:

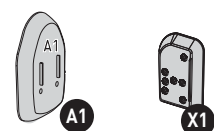

For 1.90cm (3/4in) skirting board use:

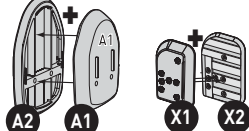

Never use just backing Spacers (A2, X2) to mount gate, they must always be used in conjunction with front Spacers (A1, X1) **!**

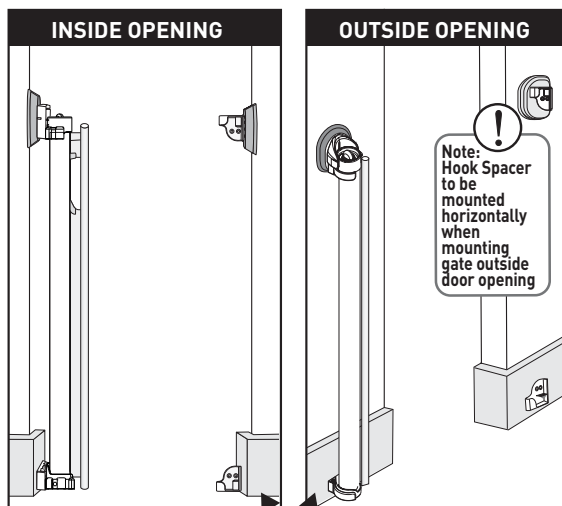

Skirting board

## 1g. Adaptor Panel (sold separately).

To provide a flat surface to install gate.

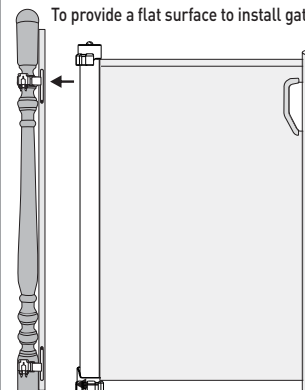

**F895** Gate Adaptor Panel

## 1h. Mounting Set (sold separately).

Use 2 sets of wall mounts to easily relocate gate from one doorway to another.

**F959** Mounting Set

To purchase accessories, contact Tee-Zed Products for your nearest retail outlet: [info@tee-zed.com.au](mailto:info@tee-zed.com.au)

## 2. Select the Templates to use to suit your chosen gate position.

<p><b>Mounted Inside Opening</b></p> <p>1</p> <p>door open right to left</p> <p>Use Bracket Template 1 and Hook Template -2</p>	<p><b>Mounted Inside Opening</b></p> <p>3</p> <p>door open left to right</p> <p>Use Hook Template 3 and Bracket Template -1</p>	<p><b>Mounted Outside Opening</b></p> <p>1</p> <p>door open right to left</p> <p>Use Bracket Template 1 and Hook Template -4</p>	<p><b>Mounted Outside Opening</b></p> <p>5</p> <p>door open left to right</p> <p>Use Hook Template 5 and Bracket Template -1</p>
---	---	--	--

## 3. Locate the frame/stud and overlay Hook and Bracket Templates.

Keep the Templates vertical and ensure lower edge is directly on the floor.  
Mark hole positions with a pencil.

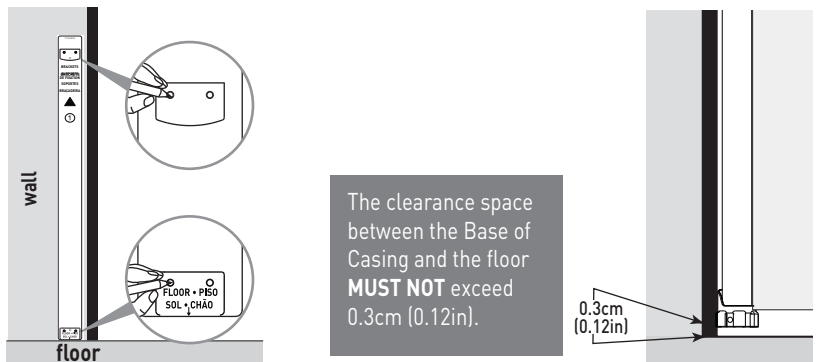

## 4. Screw in Brackets and Hooks (C,D,E,F) into wall or door frame using screws (H) and if masonry or brick using Plugs (I).

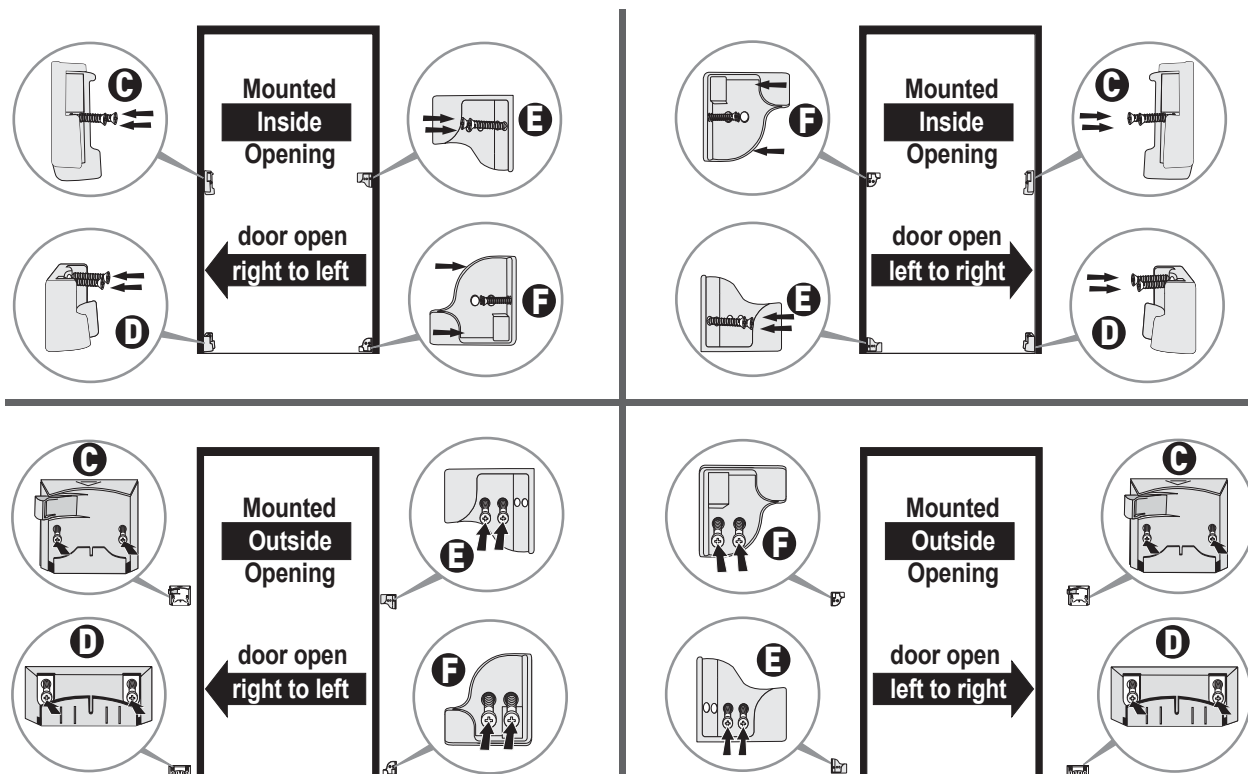

## 5. To mount gate

**5a** Checked the direction you want the gate to open / close.

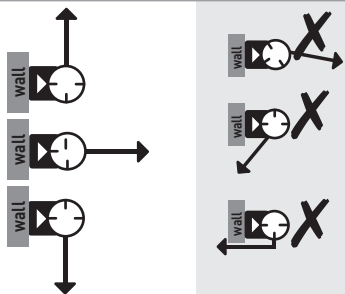

**5b** Align the notch on Top of Casing (L) with the arrow on the Upper Bracket (C) in desired open / close direction.

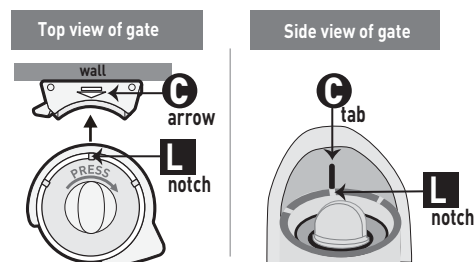

**5c** Align the lower part of gate to Lower Bracket (D) and top of gate to Upper Bracket (C). Push down gently to click into place.

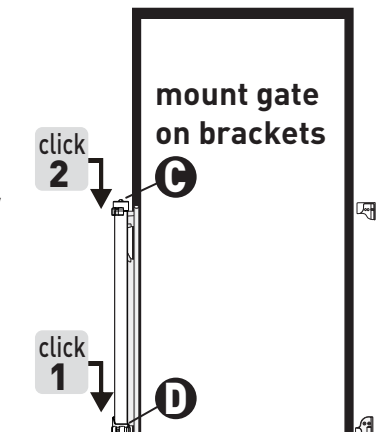

**5d** Slide Cover (B) over Upper Bracket (C) until it covers dismount Latch.

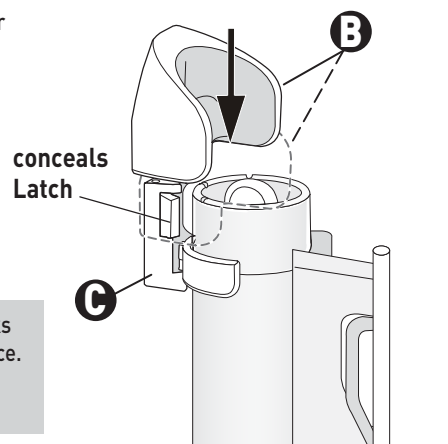

**! The Cover locks the gate in place. It must be securely installed at all times.**

## TO USE

### To close the gate:

Press Release Button and twist clock-wise, then pull the gate handle and without stopping fit Locking Rod (G) into lower and upper Hooks (E, F).

### To open gate:

Press Release Button and twist clock-wise then pull the gate handle out from lower and upper Hooks (E, F).

**NOTE:** The noise you hear while the gate retracts is designed to alert you, letting you know that the gate is being opened.

For silent operation, hold Release Button down when retracting gate.

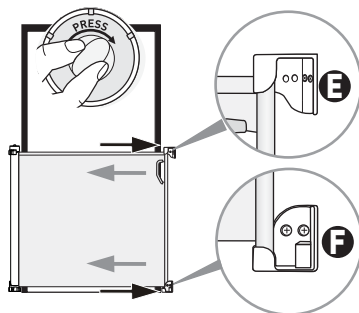

## TO REMOVE

Slide Cover (B) from Top of Casing (L).

Press dismount Latch on Upper Bracket (C) and slide gate up.

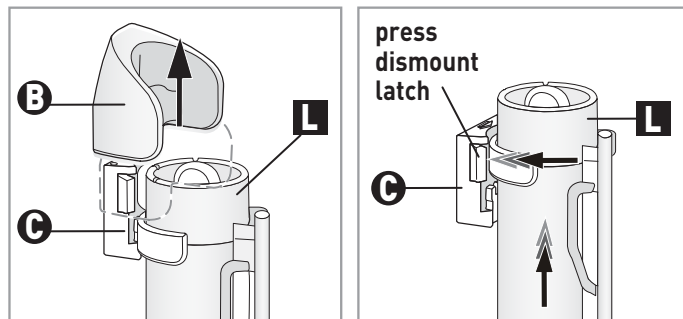

## MAINTENANCE & CARE

- Gate must be fitted according to instructions, to ensure it works correctly.
- Regularly check gate to ensure it is fitted properly and securely. Adjust as required.
- Regularly check that brackets and hooks are securely in place.
- If gate is used outdoors, bring inside and keep out of rain, hail, snow or below freezing conditions.
- Do not use the safety gate if any components are damaged or missing.
- To clean, wipe surface with a damp cloth or sponge using mild detergent and warm water. Never clean with abrasive, ammonia based bleach based or spirit type cleaners.
- Any additional and replacement parts should be obtained from Tee-Zed Products.

### Composition

The plastic parts are made of fibreglass-armed polyamide, Polypropylene and Polyester. Plastic parts: Nylon & Polyoxymethylene (POM) materials. Mesh fabric made of 40% polyester and 60% non-toxic PVC coating. Other components are made of steel and aluminium. The materials are used for their durability and resistance. Spacers made of ABS (Acrylonitrile Butadiene Styrene).

## CONTACT DETAILS

Tee-Zed acknowledges that its customers may be entitled to statutory consumer guarantees and does not seek to exclude or limit them. These guarantees include that Tee-Zed's products are of acceptable quality.

This Tee-Zed product is for the specific purpose detailed in the instructions and packaging and Tee-Zed considers use outside of that purpose to be abnormal use. To the maximum extent permitted by law, Tee-Zed does not accept any liability for damage:

- arising from abnormal use of the products;
- caused by installation or removal of the products other than in accordance with the supplied installation and removal instructions; or
- arising under the law of tort or contract.

Dreambaby® products by **Tee-Zed**

Made in Shenzhen, China.

©2019 Tee-Zed Products Pty Ltd



Tee-Zed Products Pty Ltd, PO Box 2022  
Bondi Junction NSW 1555  
**Australia** ☎ +61 (0)2 9386 4000  
✉ info@tee-zed.com.au  
**www.dreambaby.com.au**

Tee-Zed Products (N.Z.) Ltd, PO Box 64013  
Botany Town Centre Auckland  
**New Zealand** ☎ +64 (0)9 274 8788  
✉ info@tee-zed.co.nz  
**www.dreambaby.co.nz**

Tee-Zed Products Ltd, PO Box 29227  
Dunfermline, KY12 2DN  
**United Kingdom** ☎ +44 (0)844 800 9445  
✉ info@tee-zed.co.uk  
**www.dreambaby.co.uk**



**You Tube**  
**dreambabytv**