



# INSTRUCTIONS:

## Royale Converta® 3-in-1 Play-Pen Gate

•Play-Pen •Fireplace Barrier •Wide Barrier Gate

F849  
F2003  
F2161

### IMPORTANT! KEEP FOR FUTURE REFERENCE.

Read INSTRUCTIONS thoroughly before assembling and installing gate.

If you sell or give away this product, make sure you give this Instruction to the new owner.

Complies with Standards: EN 12227:2010.



## WARNING

**WARNING – Do not place the Play-Pen close to an open fire or other heat source.**

**WARNING – Do not use the Play-Pen without the base.**

**WARNING – Ensure that the Play-Pen is fully erected and all the locking mechanisms engaged before placing your child in this Play-Pen.**

- Suitable for children up to 24 months.
- Ensure the Fireplace Barrier is installed at least **60cm/23.5in** from fire source.
- This product does not replace adult supervision. Never leave a child unattended.
- Never use with a child able to climb over or dislodge the Play-Pen/Fireplace Barrier/Wide Barrier Gate.
- Do not use at the top of stairs.



**WARNING:** This package contains small parts and sharp points in an unassembled state. Keep out of reach of children. Adult assembly required.

## COMPONENTS

- A** Gate Panel
- B** Barrier Panel
- C** Upper Securing Hinge
- D** Securing Screw
- E** Lower Hinge
- F** Vertical Bar
- G** Vertical Bar Top Casing
- H** Gate Release Switch
- I** Gate Upper Lock
- J** Gate Lower Lock

### Wall Mounting Parts

- K** Upper Mount ( Side X)
- L** Upper Mount ( Side Y)
- M** Lower Mounts
- N** Wood Screws (38mm / 1.5in)
- O** Lower Hinge Cap (Installed)
- P** Floor Cap

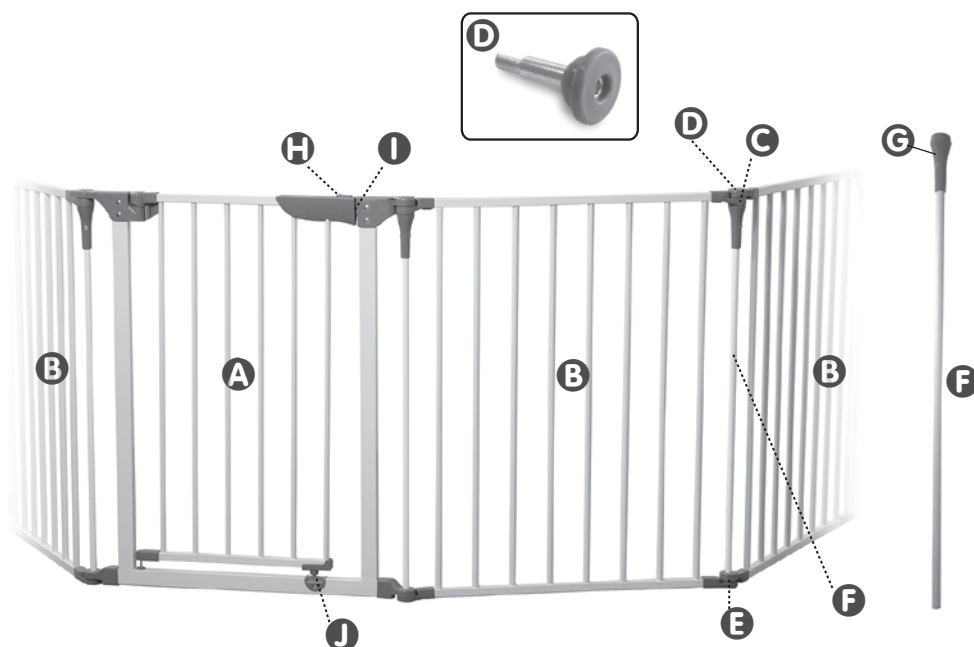

### Required for Assembly/mounting

- Q** Allen Key (4mm)

**NOTE:**  
Store Allen Key safely  
out of reach of children.  
Keep for future use.

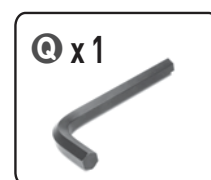
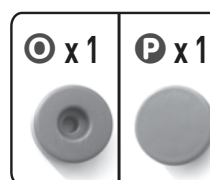
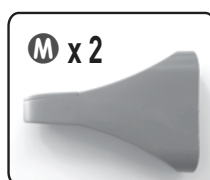
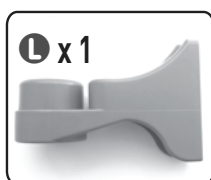
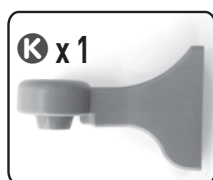

# PLAY-PEN ASSEMBLY

**1** Remove Play-Yard from packaging and place upright on flat surface.

**2** Position panels to desired shape.

**3** The vertical bars **F** at each end of the Play-Yard must first be removed.

**Note-** For Play-Yard assembly only one of these vertical bars are required.

The other vertical bar is only used when wall mounting as a barrier gate or fire barrier, store for future use. For shipping purposes one of these vertical bars is temporarily secured at the lower hinge **E** with a securing screw **D**.

- Use Allen Key **A** to remove securing screw **D** from upper securing hinge **C**, and lower hinge **E**.  
Keep screws for future use. Keep out of reach of children.
- Release the vertical bars **F** from the upper securing hinge **C** by pulling down on the top casing **G**.
- Twist to release and remove vertical bar **F** from lower hinge **E**.

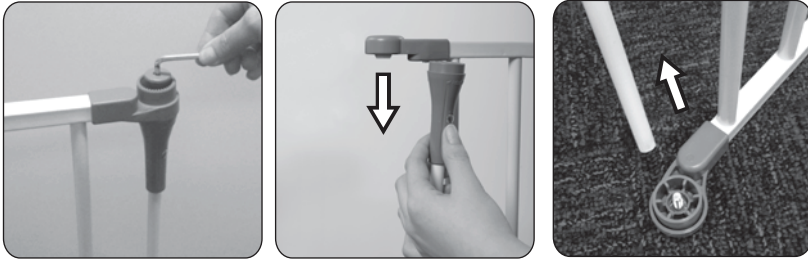

**4** Join panels by connecting upper securing hinge **C** and lower hinge **E**.



**5** Install vertical bar **F**.

- Insert vertical bar into lower hinge **E**. Twist to lock into place.
- Pull down top casing **G** and insert into upper securing hinge **C**.
- Insert securing screw **D** and position in place with Allen Key **A**.



**6** Position Play-Pen into desired shape, then lock and secure by firmly tightening all securing screws **D** using Allen Key **A**.



**A** x 1



# BARRIER GATE OR FIREPLACE BARRIER INSTALLATION

**CAUTION:** Ensure fireplace barrier is installed at least 60cm/23.5in from fire source.



Ensure the surface you mounting the barrier is structurally sound such as solid timber, brick or masonry. For plaster/gypsum surface, locate the timber beam or stud behind and mount in this location (mounting on plaster/gypsum alone is not strong enough and not safe). **Do not mount to glass.**

- 1 Follow steps 1-3 of Play-Pen assembly.
- 2 Locate best position for barrier gate/fireplace barrier to be installed.  
Position panels to desired shape placing end panels close to the wall.
- 3 Cut out templates and position on wall.

**Note-** The 2 ends of the barrier gate/fireplace barrier are different. Match the template to correct end.

- 4 Mark screw holes.
- 5 Drill holes.

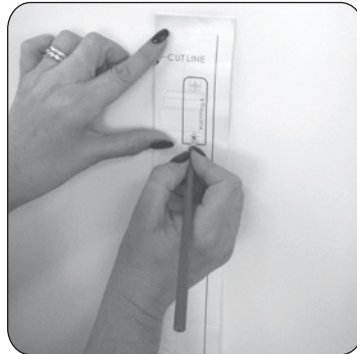

- 6 Install wall mounts Side X and Side Y.

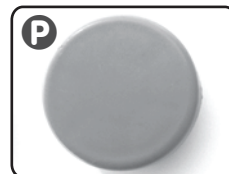
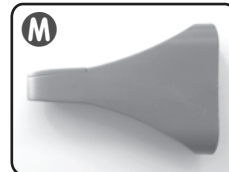
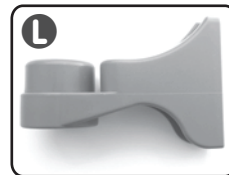
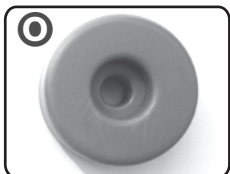
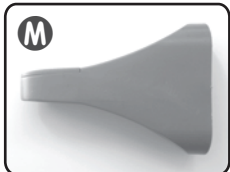

**SIDE X**

- Insert upper mount **K** and lower hinge cap **O**.
- Thread lower mount **M** onto vertical bar **F**.
- Install vertical bar **F** into lower hinge cap **O** and upper mount **K**.
- Insert securing screw **D** and position in place with Allen Key **Q**.

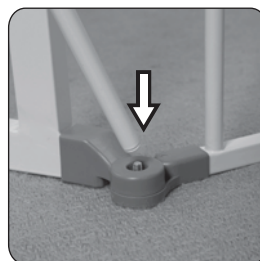
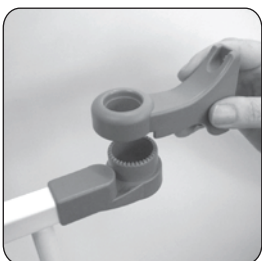



## SIDE Y

- Thread lower mount **M** onto vertical bar **F**.
- Install floor cap **P** under lower hinge **E**.
- Insert upper mount **L** onto upper securing hinge **C** and hold in place.
- Insert vertical bar **F** into lower hinge **E** and upper mount **L**.
- Insert securing screw **D** and position in place with Allen Key **Q**.



- 7** Align both sides with template and affix with screws **N**.

**N** x 8



Wood Screws

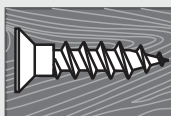

Wood screws **N** included.  
For Brick or Masonry use the appropriate fittings, screws and plugs for your wall (not included)

- 8** Position barrier gate/fireplace barrier into desired shape, then lock and secure by firmly tightening all securing screws **D** using Allen Key **Q**.



**Assembled  
Fireplace Barrier**



**Assembled  
Barrier Gate**

## GATE OPERATION

Slide the release switch **H** and lift gate panel **A**.

Gate swings in both directions.

Swing gate closed ensuring upper **I** and lower **J** locks engaged.

Swing gate fully open to engage **SMART STAY OPEN** feature.

**Caution: Keep gate closed when children are present.**

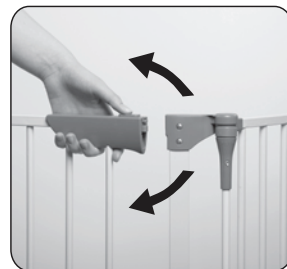
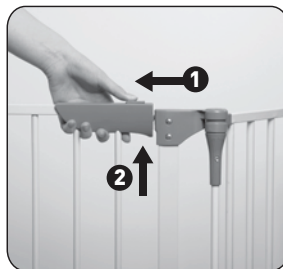

## MAINTENANCE & CARE

- Play-Pen/Fireplace Barrier/Barrier Gate must be fitted according to instructions to ensure it works correctly.
- Regularly check all parts to ensure Play-Pen/Fireplace Barrier/Wide Barrier Gate is secure. Adjust as required.
- Only use Dreambaby® spare parts.
- To clean, wipe surface with a damp cloth using mild detergent and warm water.  
Never clean with abrasive, ammonia, bleach or spirit based type cleaner.

**Look for the Dreambaby® range of Child Safety and Care Products.**

Tee-Zed acknowledges that its customers may be entitled to statutory consumer guarantees and does not seek to exclude or limit them. These guarantees include that Tee-Zed's products are of acceptable quality. This Tee-Zed product is for the specific purpose detailed in the instructions and packaging and Tee-Zed considers use outside of that purpose to be abnormal use. To the maximum extent permitted by law, Tee-Zed does not accept any liability for damage:

- arising from abnormal use of the products;
- caused by installation or removal of the products other than in accordance with the supplied installation and removal instructions; or
- arising under the law of tort or contract.

Dreambaby® products by



Tee-Zed Products Pty Ltd  
PO Box 2022,  
Bondi Junction NSW 1355  
Australia  
☎ +61 (0)2 9386 4000  
✉ info@tee-zed.com.au  
[www.dreambaby.com.au](http://www.dreambaby.com.au)

Tee-Zed Products (N.Z.) Ltd  
PO Box 64013,  
Botany Town Centre Auckland  
New Zealand  
☎ +64 (0)9 274 8788  
✉ info@tee-zed.co.nz  
[www.dreambaby.co.nz](http://www.dreambaby.co.nz)

Tee-Zed Products Ltd  
PO Box 29227,  
Dunfermline, KY12 2DN  
United Kingdom  
☎ +44 (0)844 800 9445  
✉ info@tee-zed.co.uk  
[www.dreambaby.co.uk](http://www.dreambaby.co.uk)



Made in Zhejiang, China.

©2018 Tee-Zed Products Pty Ltd



**dreambabysafety**

**You Tube**

**dreambabytv**